

# Evaluation of E-biking on Open Space

**OPEN SPACE BOARD OF TRUSTEES  
FEB. 8, 2023**

**MARNI RATZEL, OSMP PRINCIPAL PLANNER**

**KACEY FRENCH, OSMP PLANNING & DESIGN SENIOR MANAGER**



# Status Quo / Existing Conditions



- E-bikes are not allowed on OSMP trails
- Disposal of open space required
- ADA exception

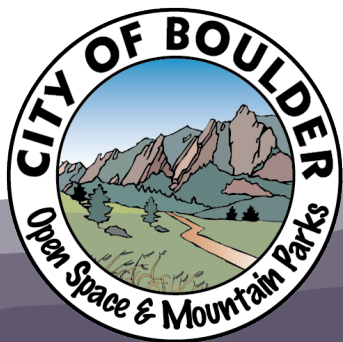



# Staff Recommendation

1

Recommend City Council allow class 1 and class 2 e-bikes on open space trails, where designated

and

2

Recommend OSMP designates and manages the trails in Alternative B for e-biking:

- Plains trails east of Broadway
- Boulder Canyon Trail

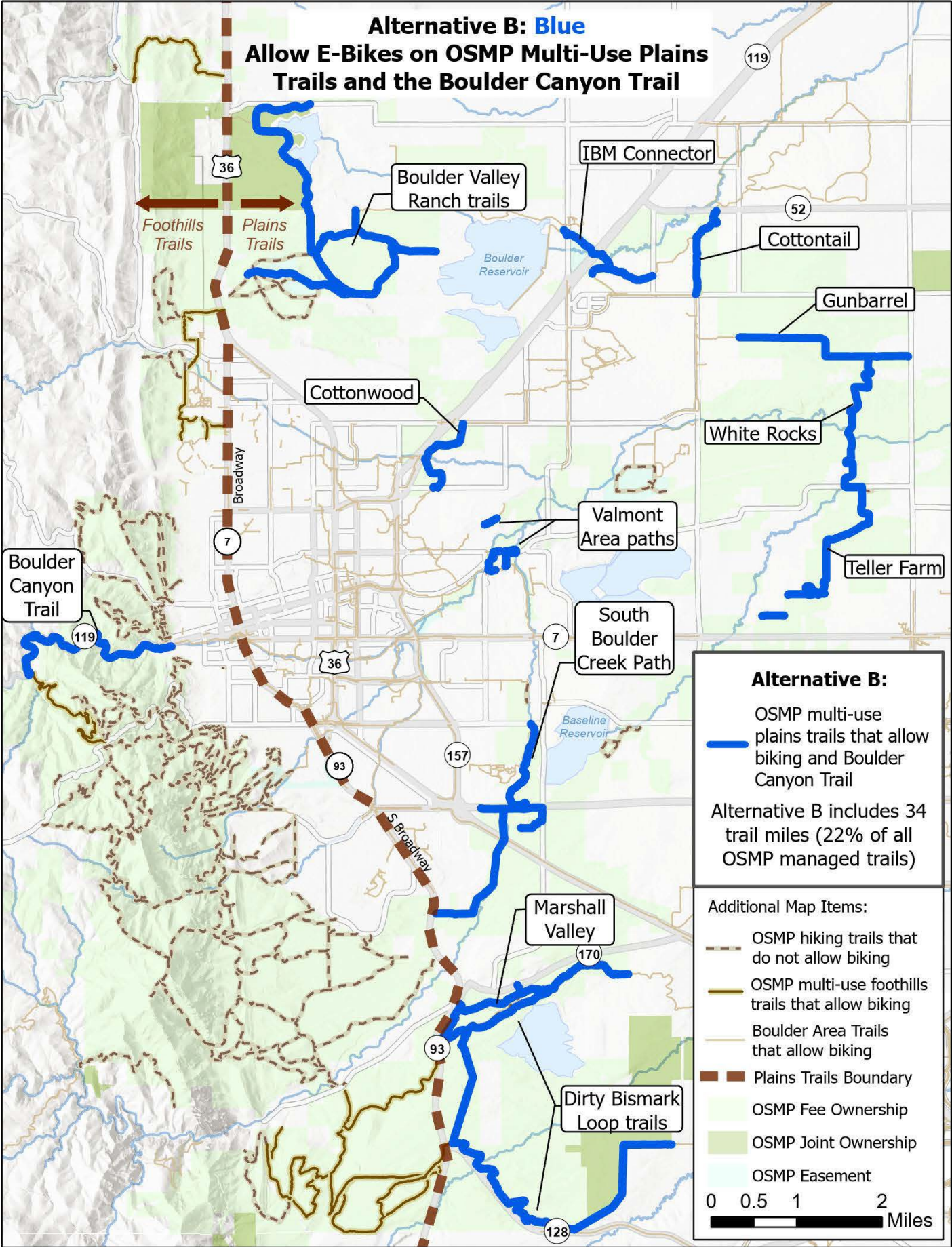
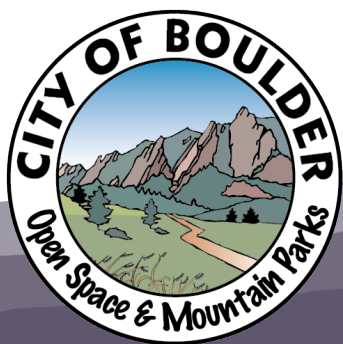

User: PhilC2 Date: 2/1/2023 Path: E:\MapFiles\Planning\E-Bike Assessment\ArcProFiles\EBikes.aprx



# Presentation Overview

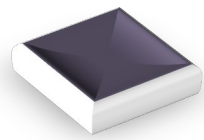

**Planning Process**

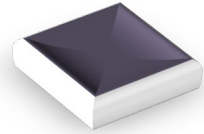

**Approach for the Staff Recommendation**

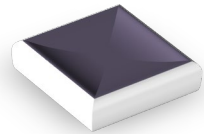

**Next steps**

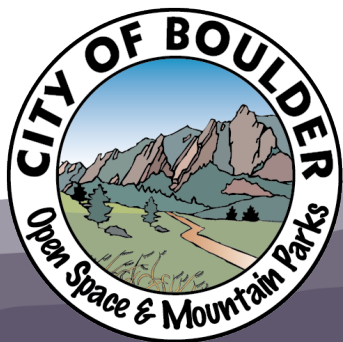

# Planning Process

## Spring 2022 Alternatives Evaluation

- Develop criteria
- Evaluate alternatives
- Identify preliminary proposal

## Summer 2022 Community Engagement

- Online questionnaire
- Onsite survey
- Office hours

## Fall 2022 Additional Analysis

- **Nov. 9:** Results and Preliminary staff recommendation
- Board request for additional information

## Winter 2023 Board Consideration

- **Dec. 14:** Public Hearing & Final Staff Recommendation
- **Feb. 8:** Board recommendation to City Council

## Spring 2023 Council Consideration

We are  
Here

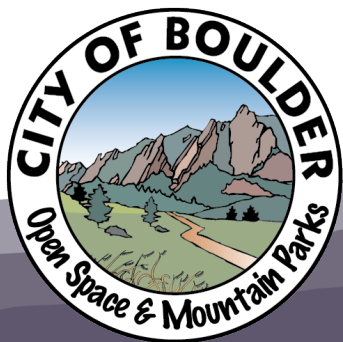

# E-biking on open space

## 1 Visitor Master Plan Activity Assessment

- 1) compatibility with other recreational activities,
- 2) compatibility with resource protection,
- 3) compatibility with existing facilities and services, and
- 4) their relationship to the natural setting.

## 2 Management Alternatives to the status quo

- A. All Trails that allow bikes
- B. Plains trails located east of Broadway, and the Boulder Canyon Trail
- C. Inter-Connected Trails that allow bicycling and are part of the regional trail

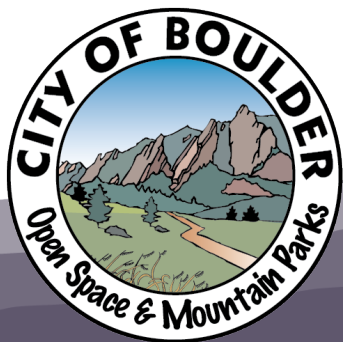



# Evaluation matrix

Criteria
Community support
Equitable access to open space lands
Consistency with other inter-connected trails
Disposal of open space
Effectiveness of regulations
Safety / Conflict
Aligned with city climate initiatives
Protection of natural resources
Visitor displacement
Trail maintenance
Visitation

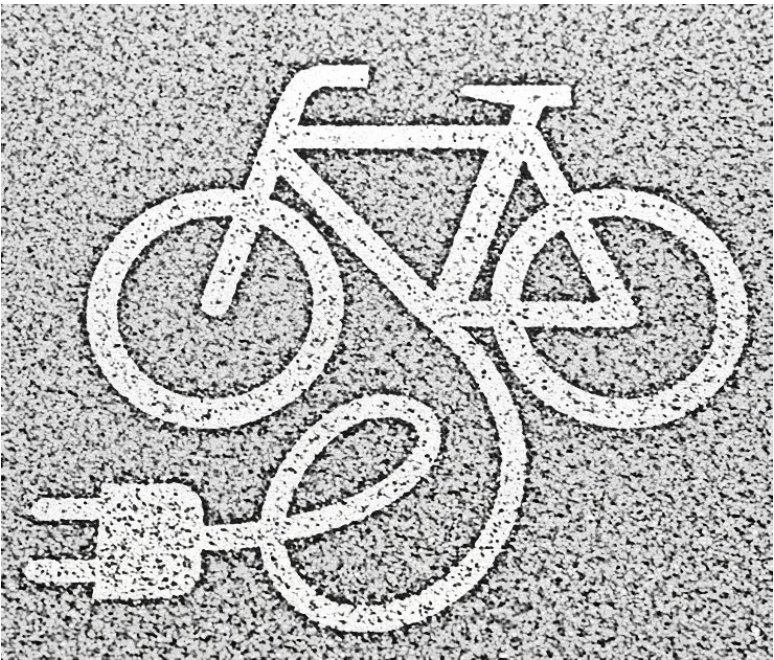
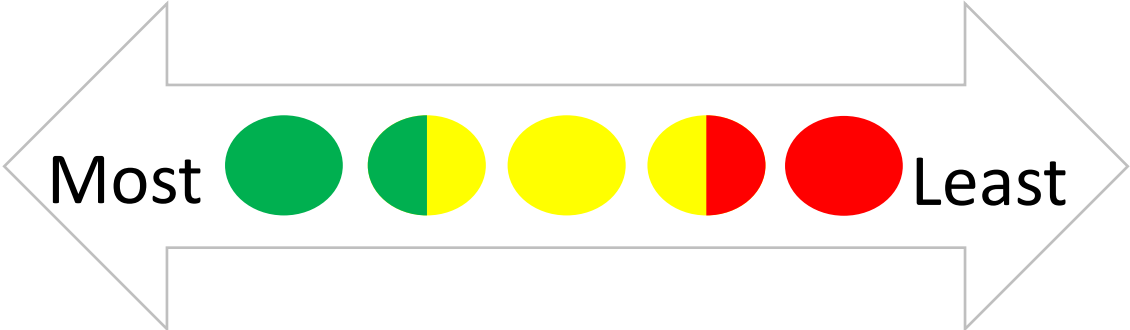

*Preliminary Staff Proposal*  
**Alternative B**

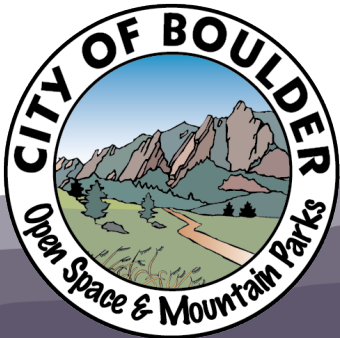



# Preferred Alternative

## Alternative B

### Plains Trails and Boulder Canyon Trail

34 miles of open space trails

22% of the 154 miles OSMP trail network

- Consistent visitor experience and regulations
- Increased equitable access
- Minimal impacts
- Supports broader city climate goals

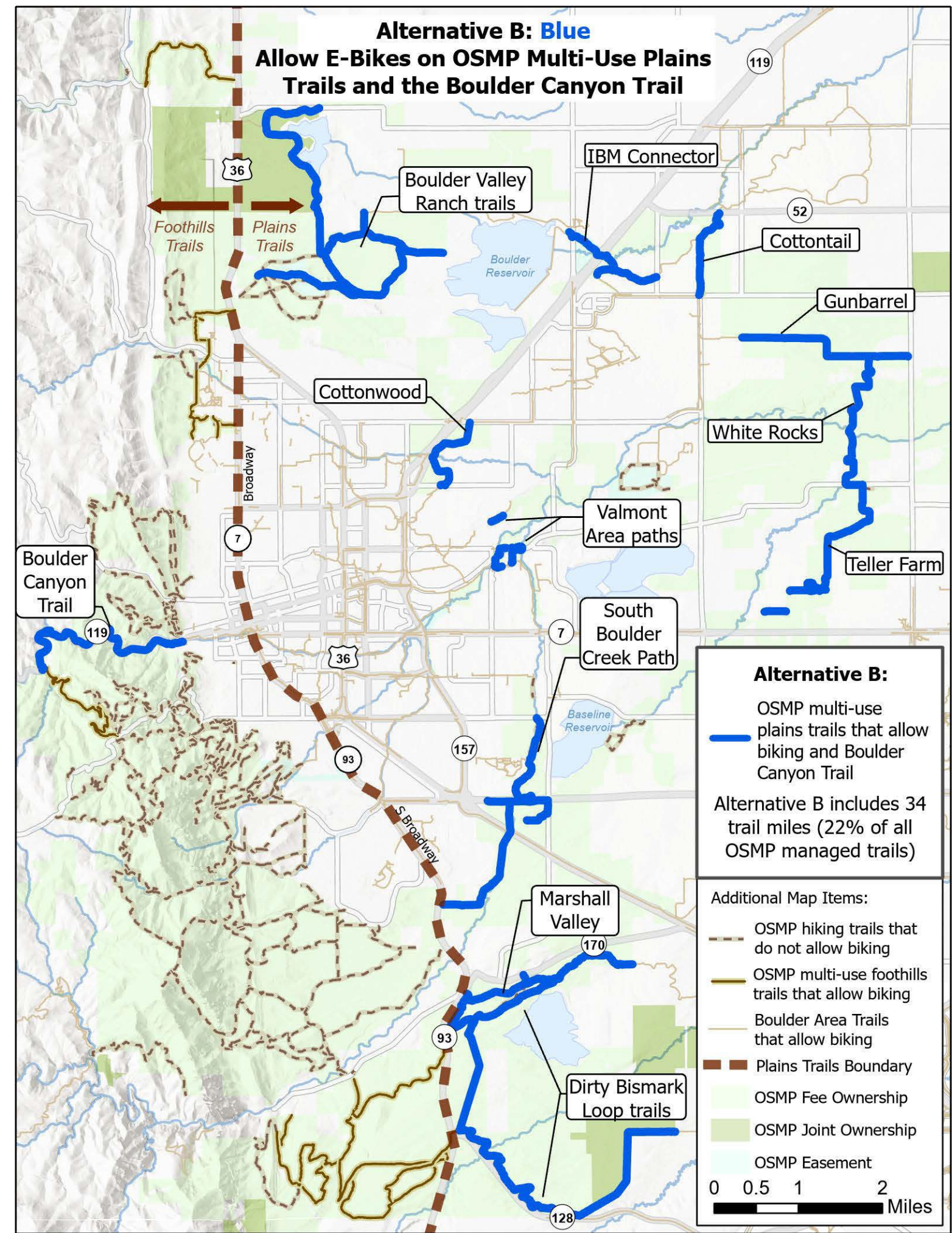
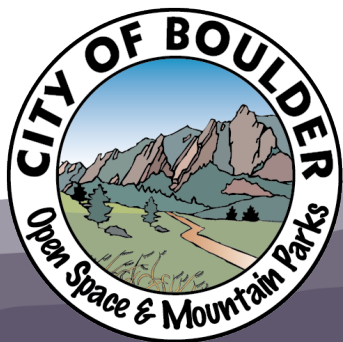



# Support for E-bikes on Open Space

## Online Engagement

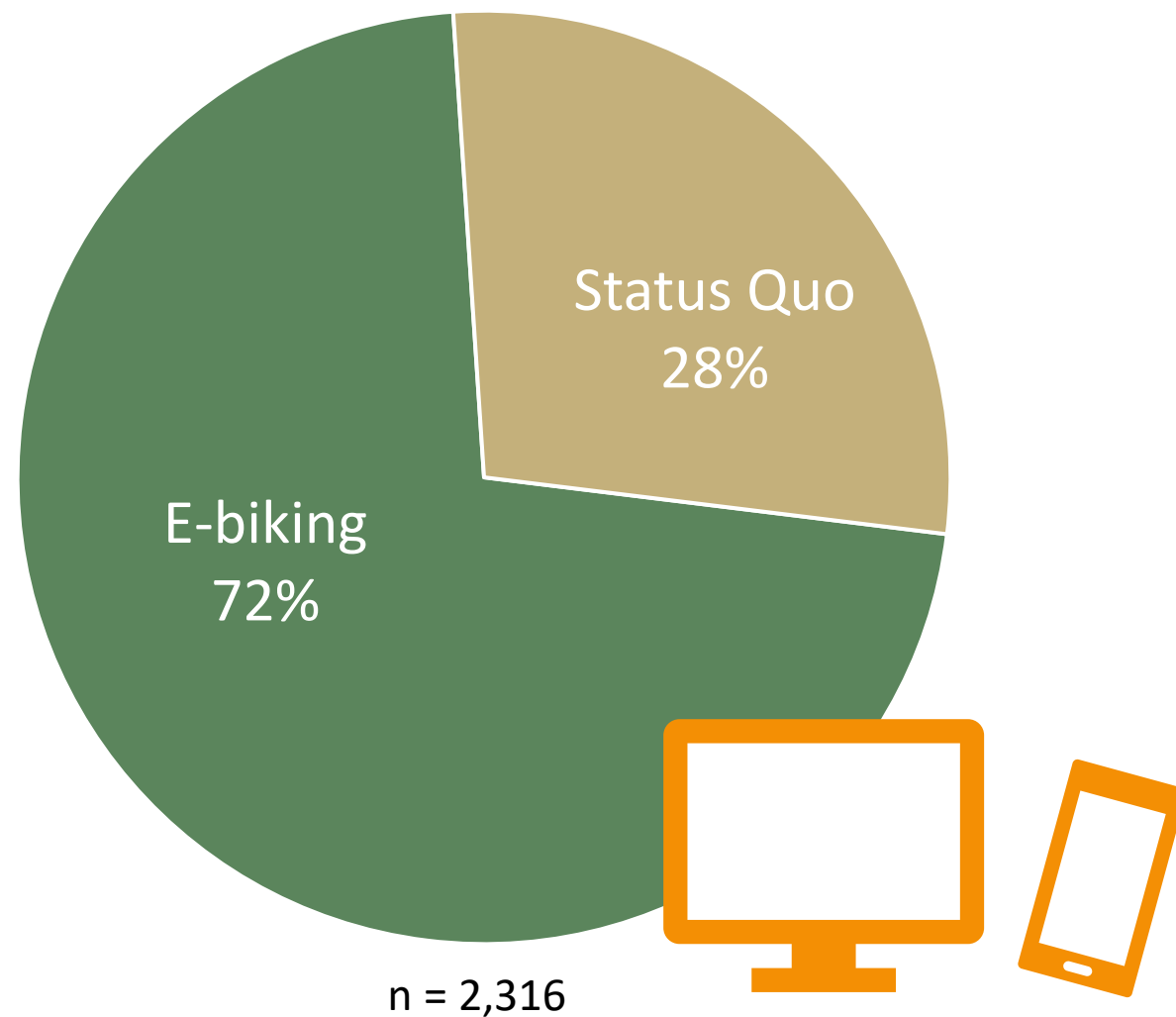

## Onsite Intercept

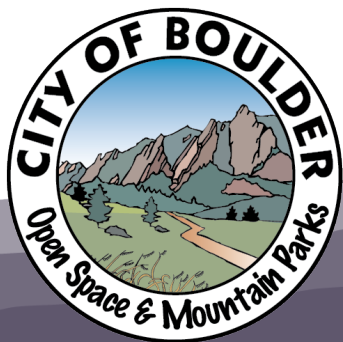
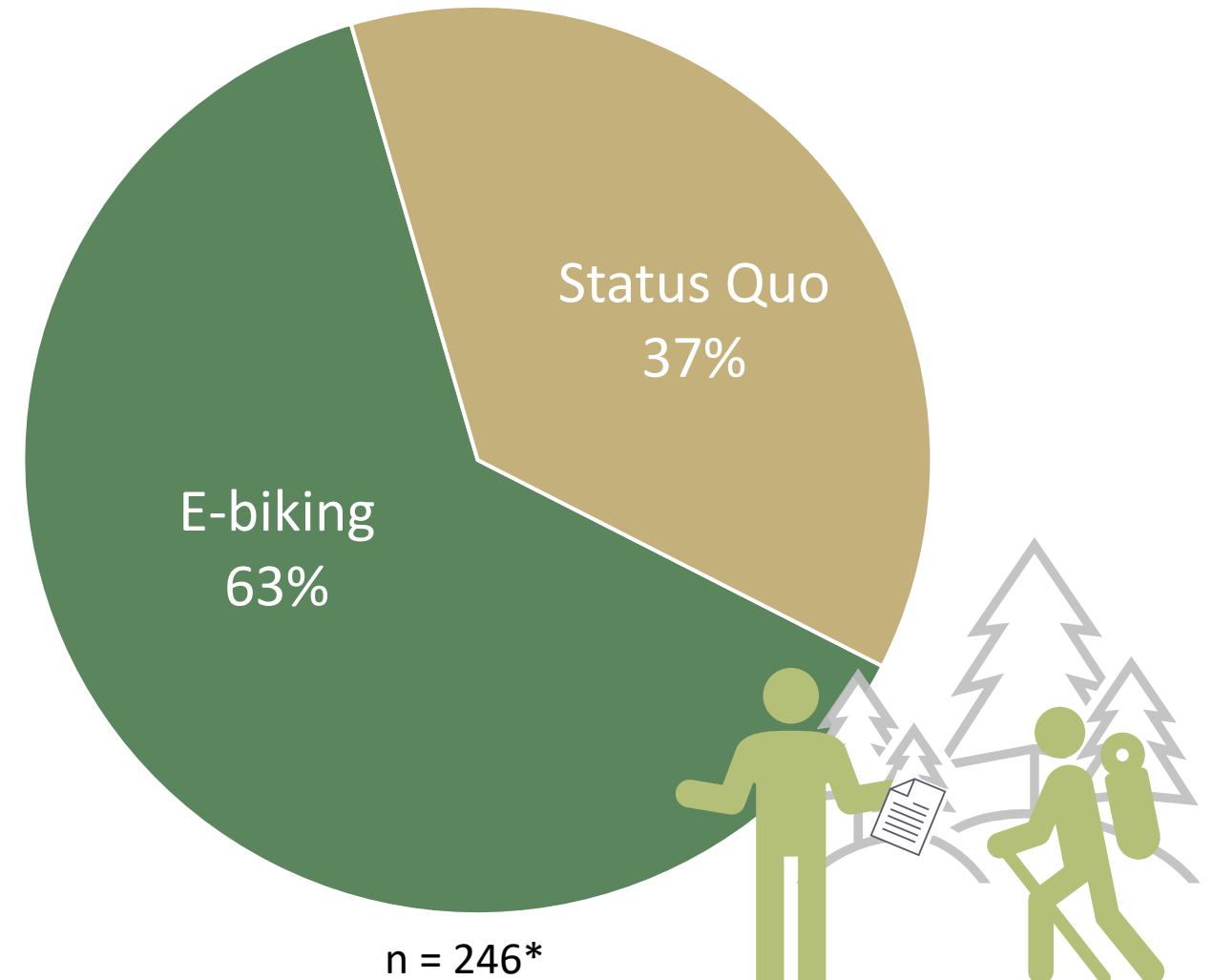

# Online Engagement

Support for alternatives or the status quo

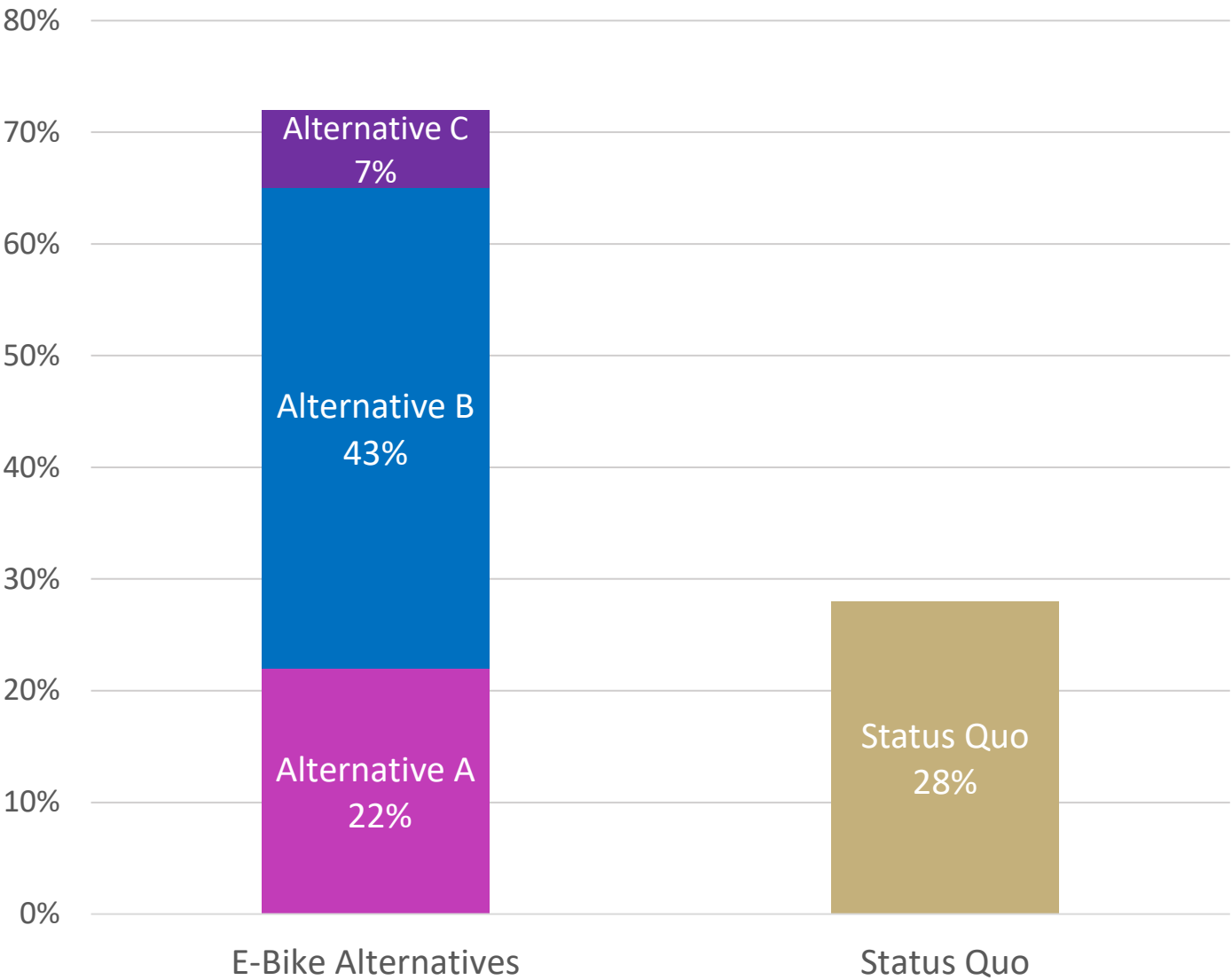

n = 2,316

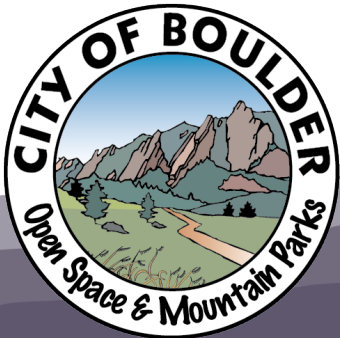



# Onsite Intercept

## Management alternatives responses

### Preference

Overall, which option do you most prefer?

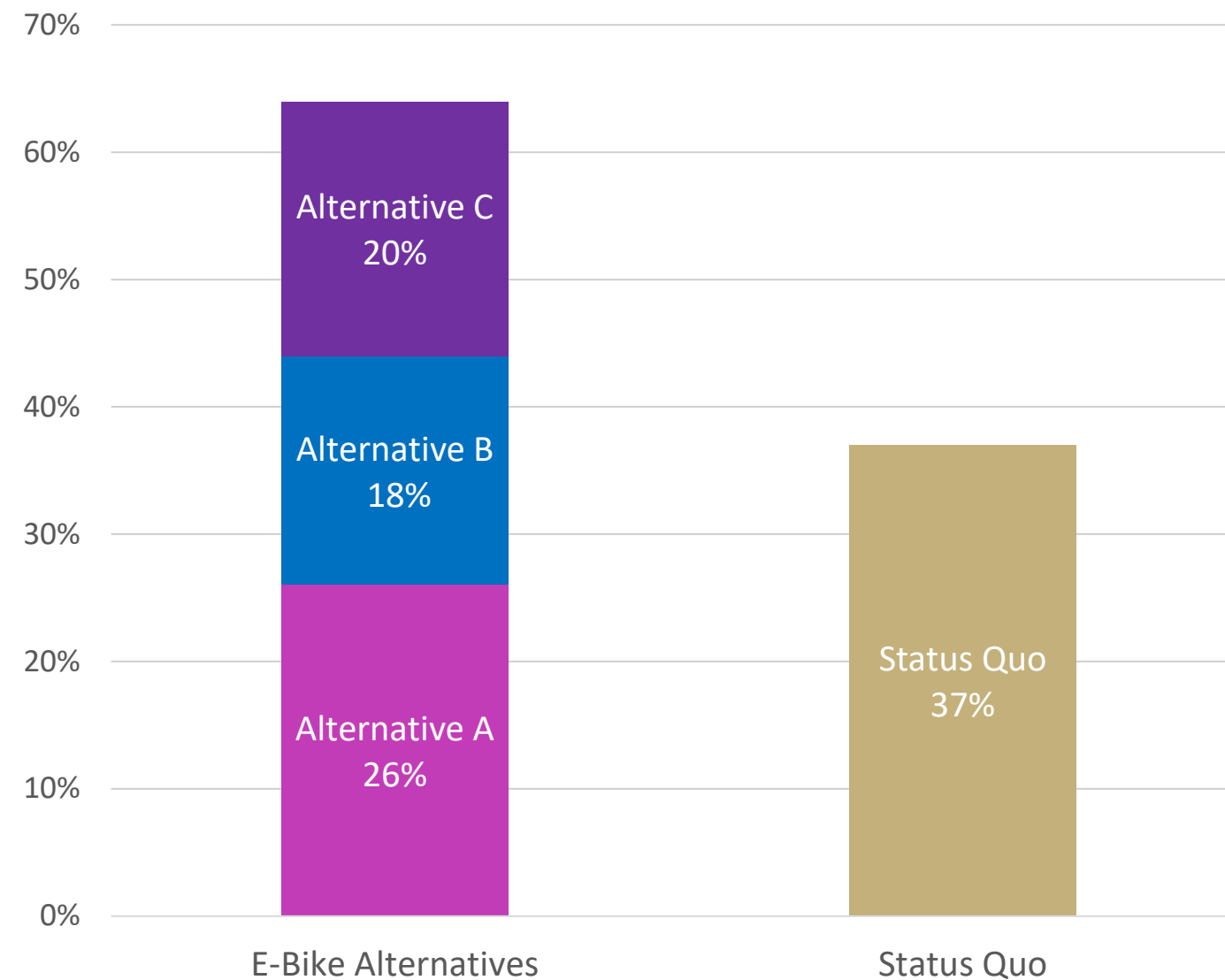

n = 246

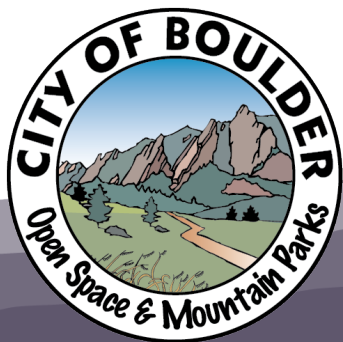

**Fall 2022**  
**Additional**  
**Analysis**

# Final Recommendation

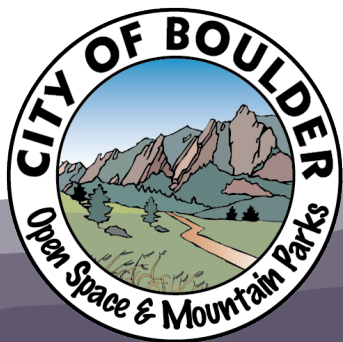
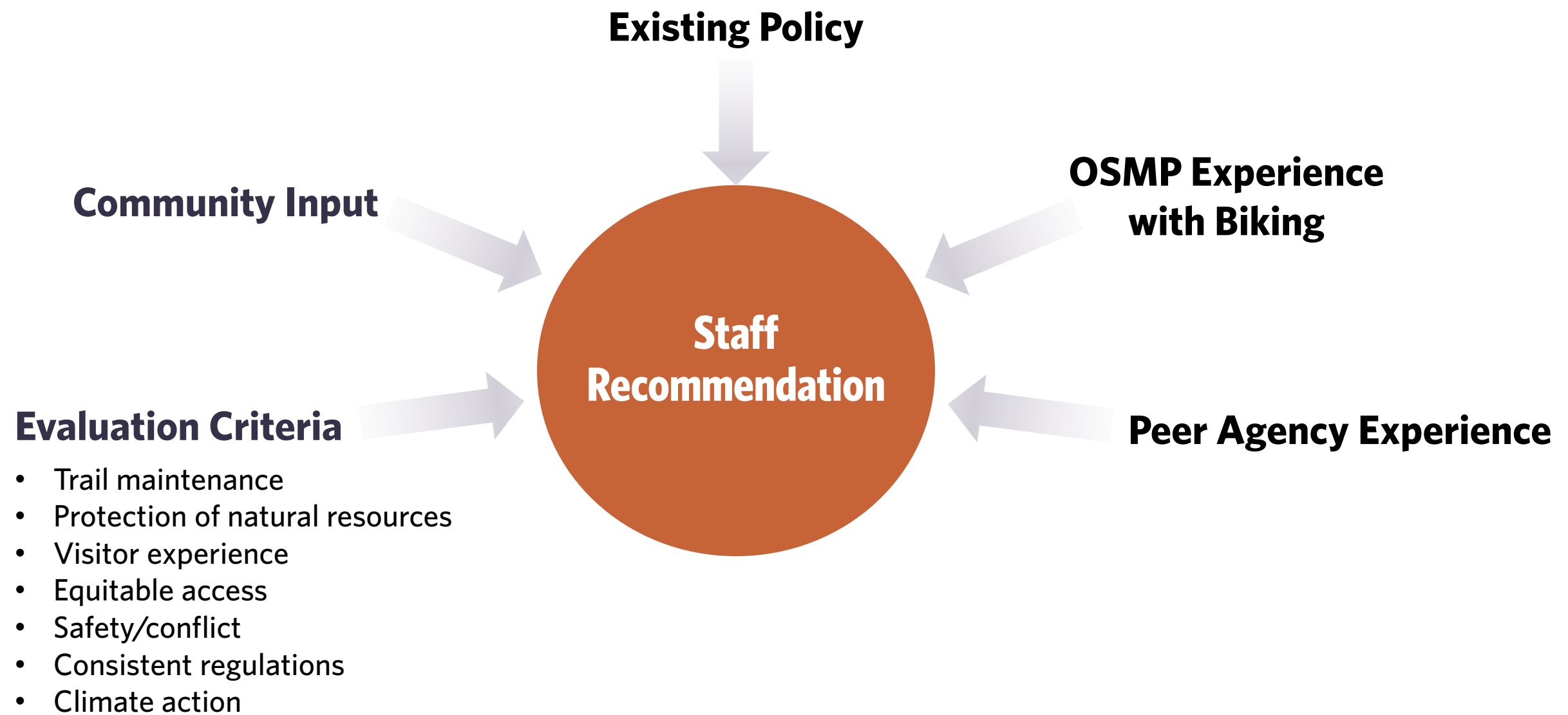



# Additional information requested from OSBT

- Additional analysis of OSMP survey data
- Summary of unique ideas from online engagement responses
- Existing and proposed Enforcement
- OSMP & Accessibility
- Research of E-bike Battery Management System (BMS)
- Widths of OSMP managed trails that allow biking
- Agency comparison of visitation on trails that allow biking

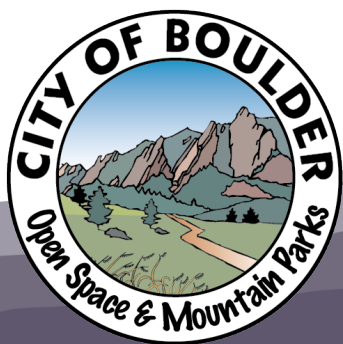
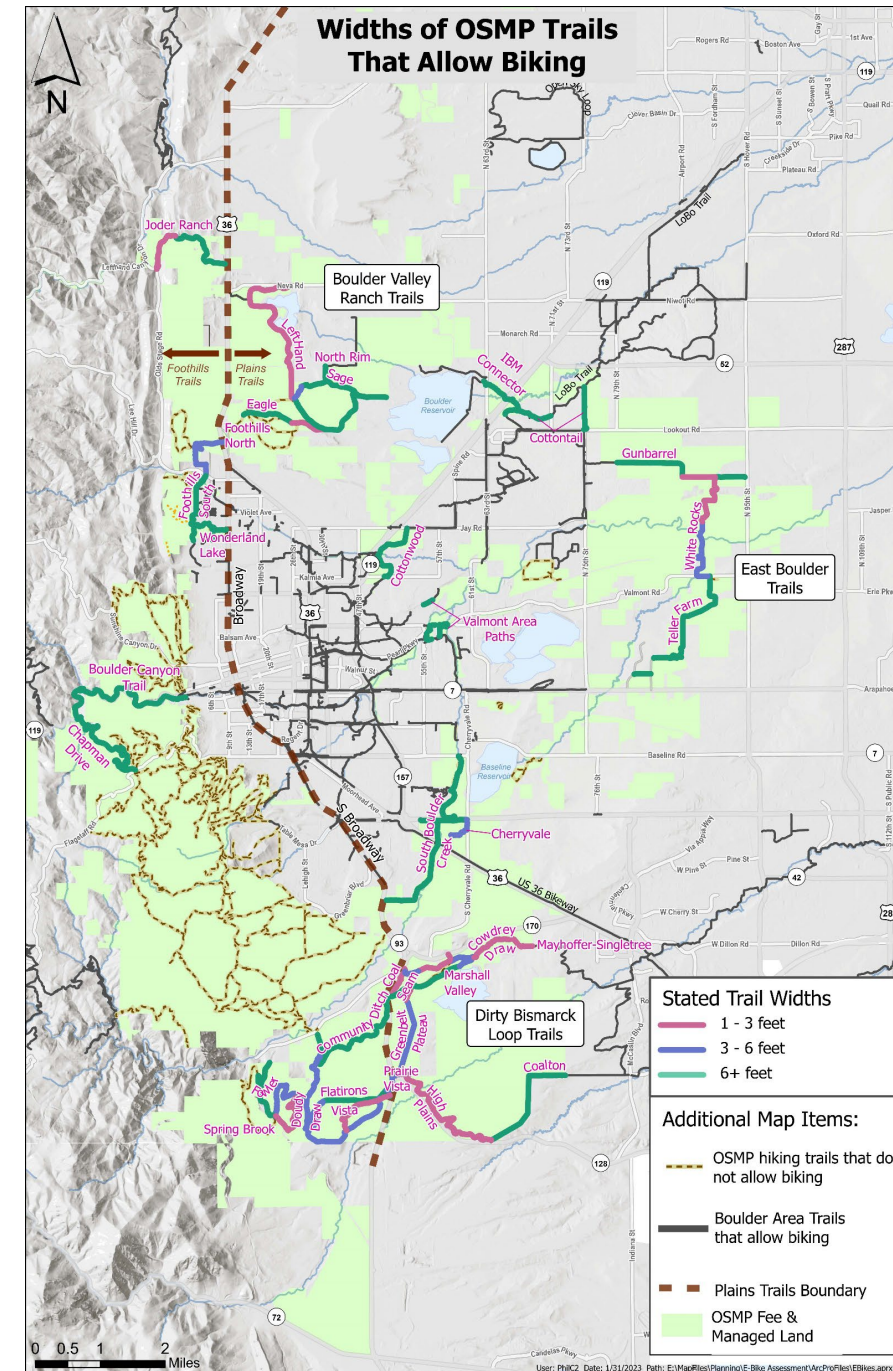

# Staff Recommendation

**Staff requests the Open Space Board of Trustees make a motion to:**

1

Recommend the Boulder City Council allow class 1 and class 2 e-biking as a passive recreational activity permissible on open space on trails where designated by the City Manager,

and

2

Recommend the OSMP Department proceed with the staff preferred alternative to implement this policy by designating and managing the trails in Alternative B - Plains trails located east of Broadway that allow biking, and the Boulder Canyon Trail for e-biking.

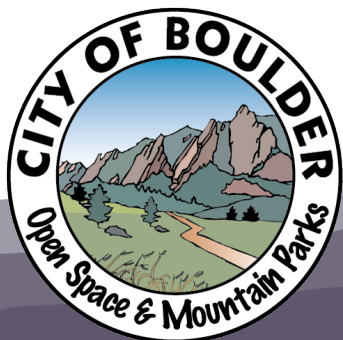



# Staff Recommended Process (How)

1

## POLICY (What):

Allowing Class 1 & Class 2 e-biking on open space

(requires Council approval)

*recommend to*

**Council**

Policy is more static while...

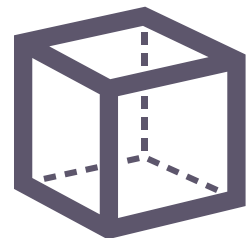

2

## IMPLEMENTATION (Where):

To proceed with designating and managing the trails in Alternative B

(on-the-ground management actions)

*recommend as*

**Input to the Department**

...implementation is more dynamic, and should be more adaptable and responsive to changing conditions.

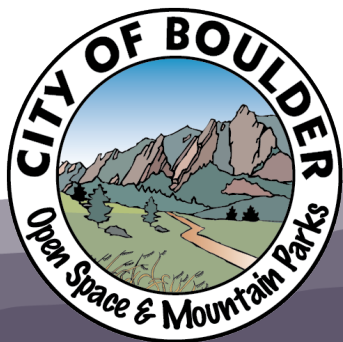
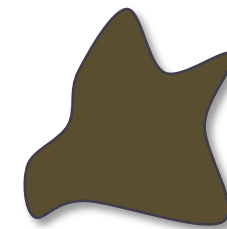

# Staff Recommended Process (How):

1

## POLICY (What):

Allowing Class 1 & Class 2 e-biking on open space

(requires Council approval)

## Process (How):

1. Legislative Finding
2. Repeal existing ordinance - in section 7-5-25 "No Electric Assisted Bicycles on Open Space"
3. Replace with a new ordinance
4. Identify the rulemaking process be used to implement the policy

2

## IMPLEMENTATION (Where):

To proceed with designating and managing the trails in Alternative B

(on-the-ground management actions)

## Process (How):

1. City Manager Rule (identifying which trails e-bikes are allowed)

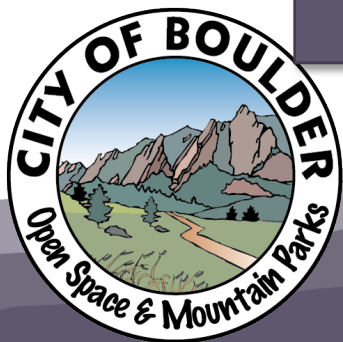



## POLICY

Allow e-biking on OSMP

### Process (How):

1. Legislative Finding

# Legislative Finding

*Charter  
Section 176:  
Open Space  
Purposes*

— . . . —  
— . . . —

**“Open space land shall be acquired, maintained, preserved, retained, and used only for the following purposes...”**

- One such purpose is preservation of land for passive recreational use

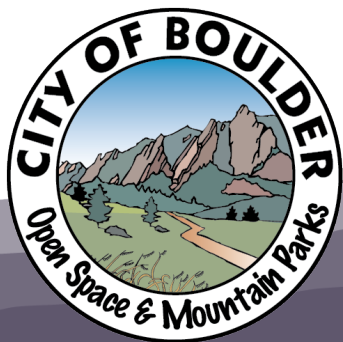

## POLICY

Allow e-biking on OSMP

### Process (How):

1. Legislative Finding

# Legislative Finding



The VMP defines passive recreation as *non-motorized* activities that achieve the following set of criteria:

- Offer constructive, restorative, and pleasurable human benefits that foster an appreciation and understanding of Open Space [and Mountain Parks] and its purposes
- Do not significantly impact natural, cultural, scientific, or agricultural values
- Occur in an Open Space and Mountain Parks setting, which is an integral part of the experience
- Require only minimal facilities and services directly related to safety and minimizing passive recreational impacts
- Are compatible with other passive recreational activities

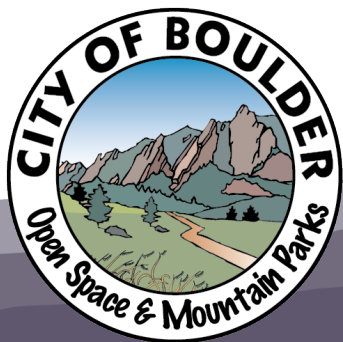

## POLICY

Allow e-biking on OSMP

### Process (How):

1. Legislative Finding

# Legislative Finding

*Charter  
Section 176:  
Open Space  
Purposes*

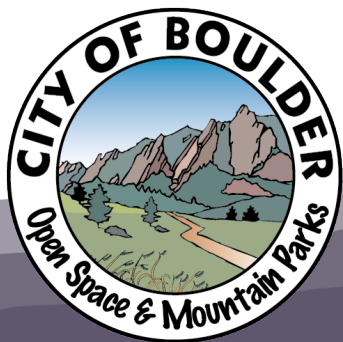
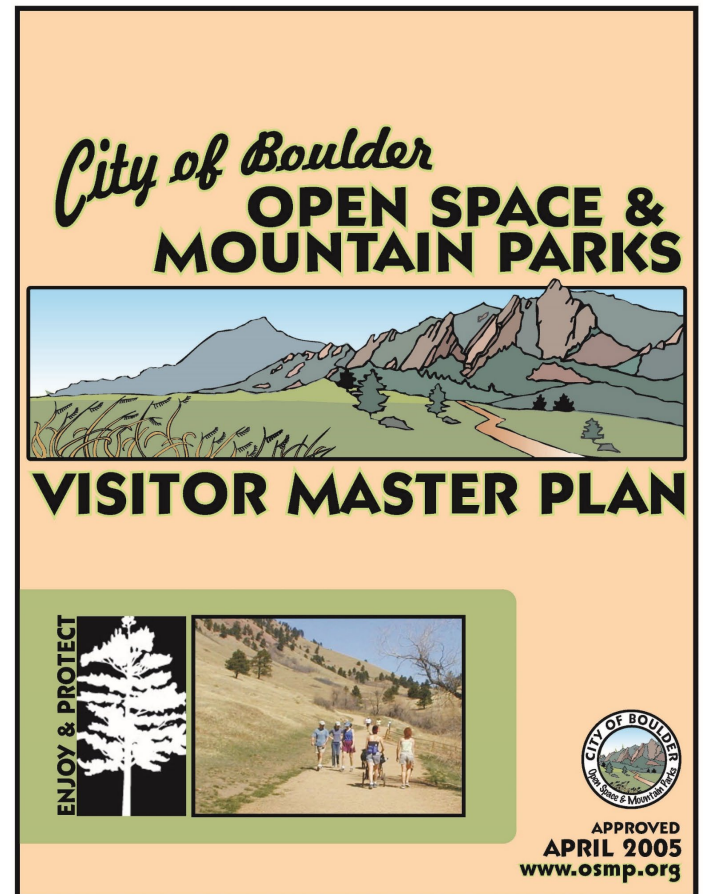



## POLICY

Allow e-biking on OSMP

### Process (How):

2. Repeal existing ordinance

# Ordinance Changes

## Repeal "Traffic Code" ordinance:

7-5-25 "No Electric Assisted Bicycles on Open Space"

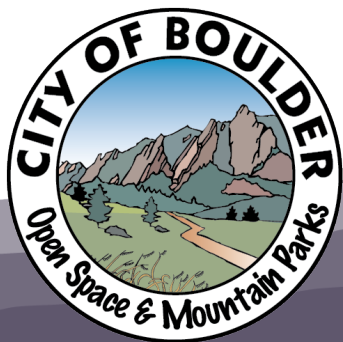
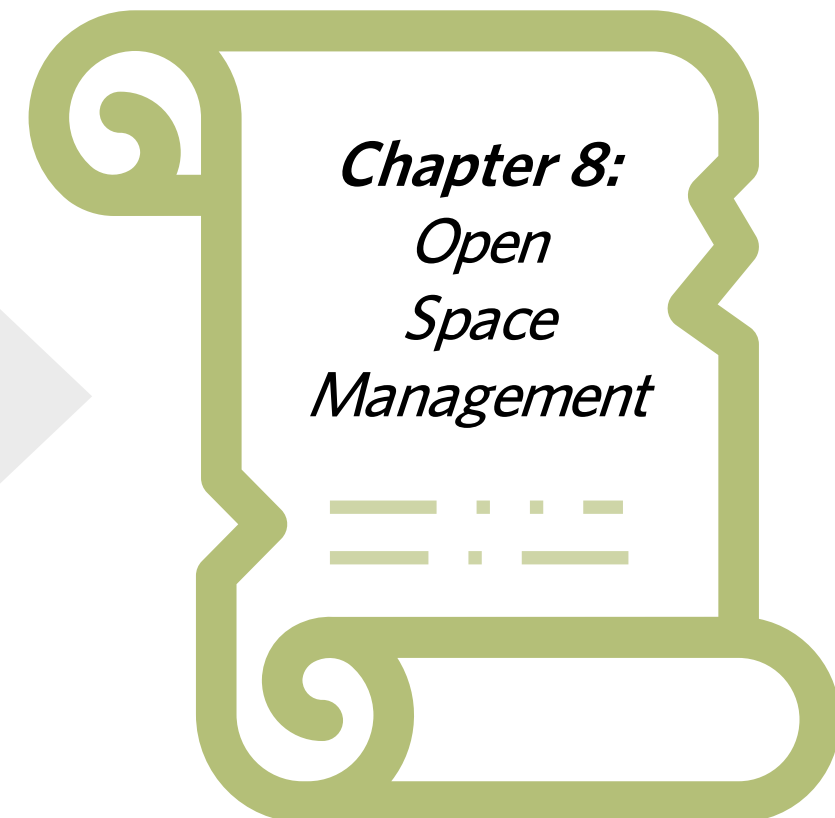
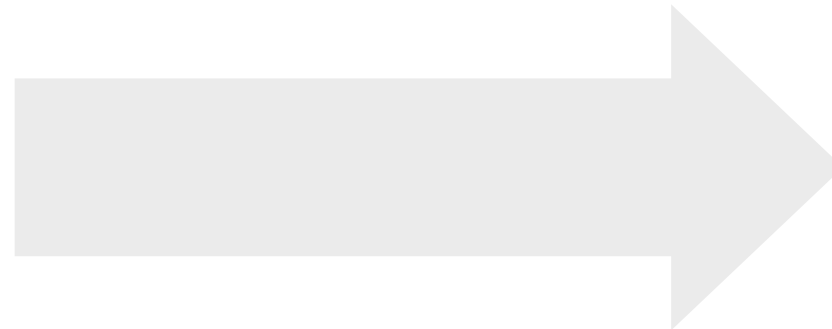
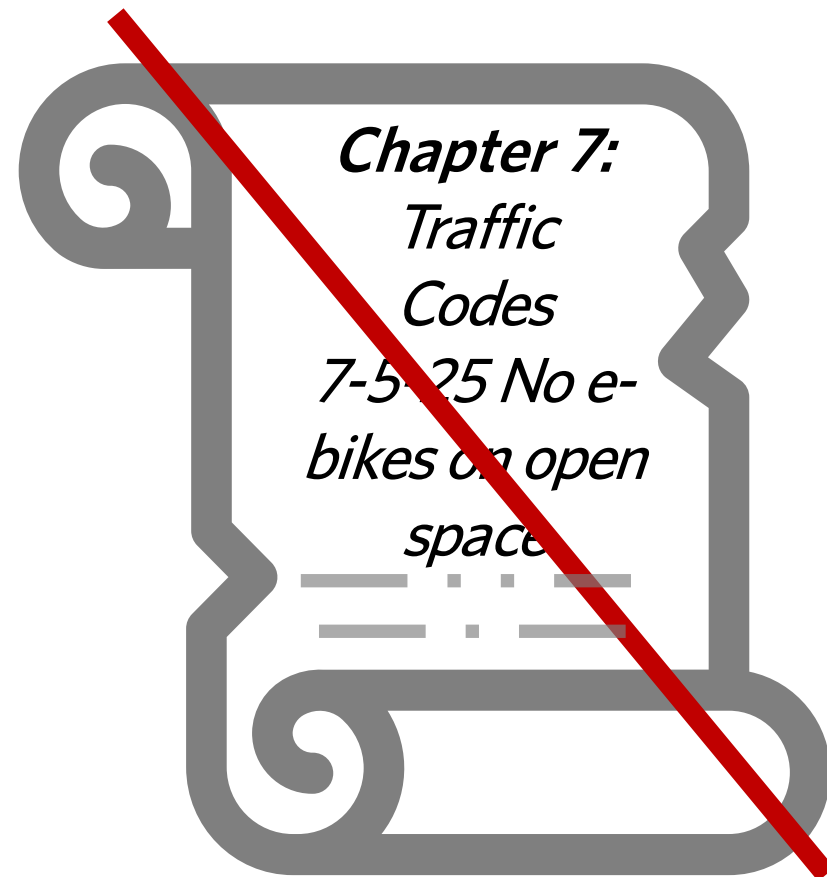

## POLICY

Allow e-biking on OSMP

### Process (How):

3. Replace with a new ordinance

# Ordinance Changes

## *Chapter 8: Open Space Management*

### **“Open Space” Ordinance:**

8-8-12 “Electric Assisted Bicycles on Open Space”

1. Legislative finding that e-biking is passive recreation
2. Allows e-bikes on certain designated open space trails
3. Establishes the City Manager Rule as the mechanism to designate trails for e-biking

**BRC amendments** to define and regulate e-biking

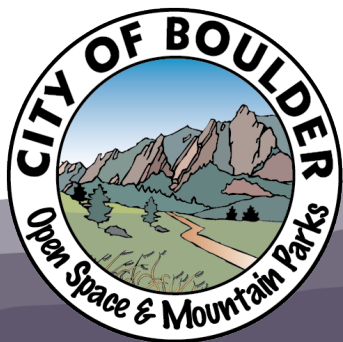

## POLICY

Allow e-biking on OSMP

### Process (How):

3. Replace with a new ordinance

# Regulations that allow open space uses by exception

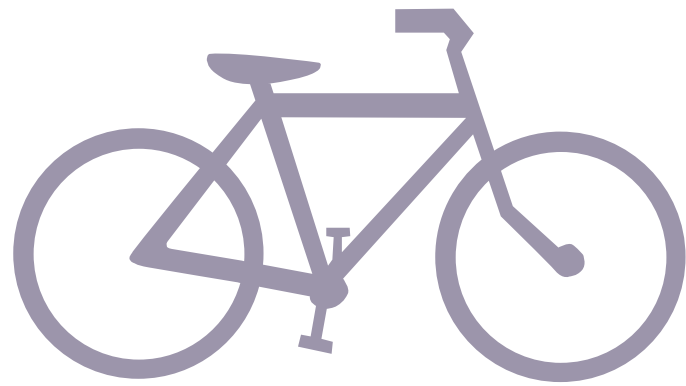

**Biking**

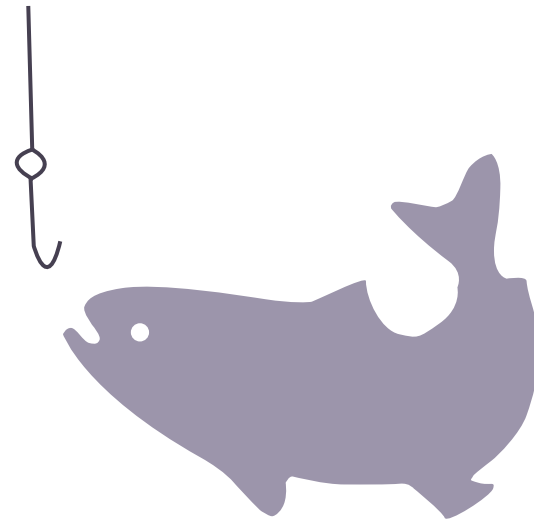

**Fishing**

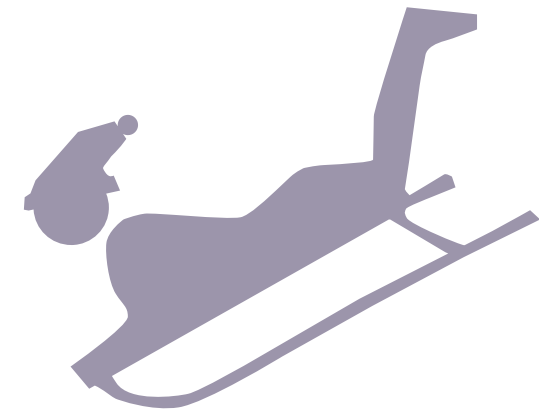

**Sledding**

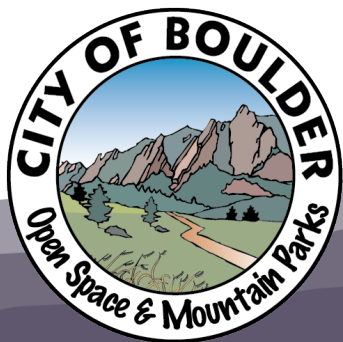



IMPLEMENTATION

Designate & Manage Trails

Process (How):

1. City Manager Rule

# City Manager Rule

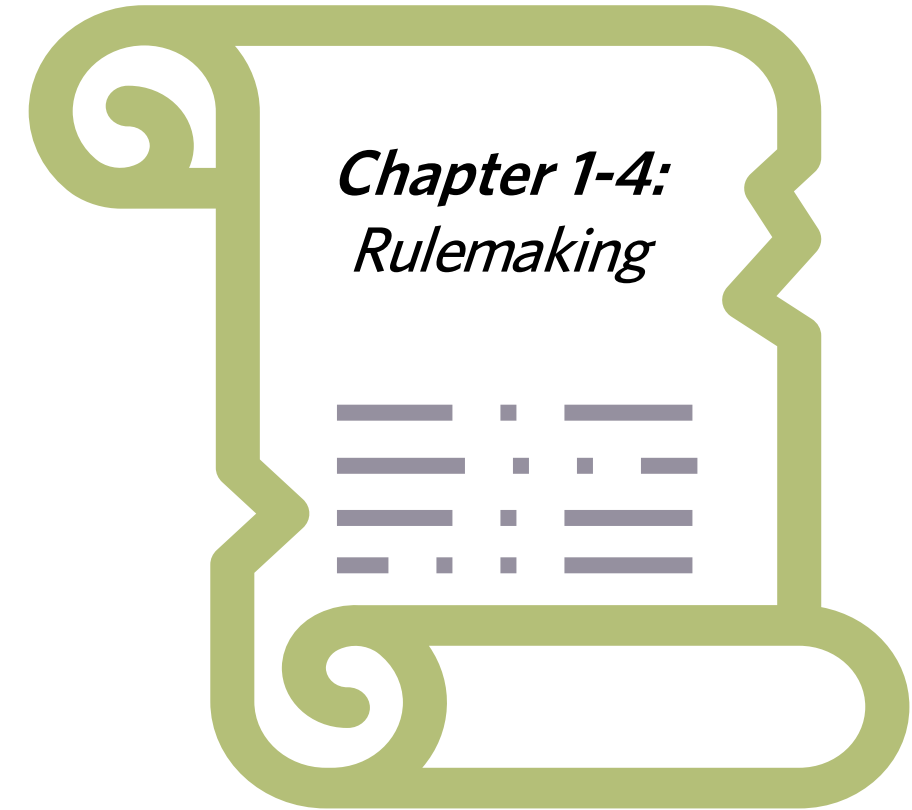

- 1 Staff identifies trails based on evaluation and input received
- 2 Staff proposes the rule to the City Manager
- 3 City Manager adopts the rule

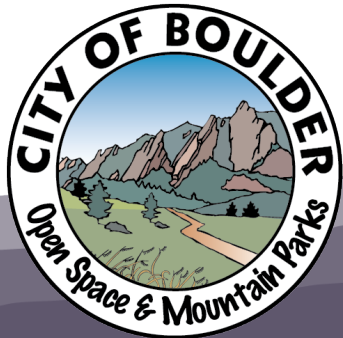
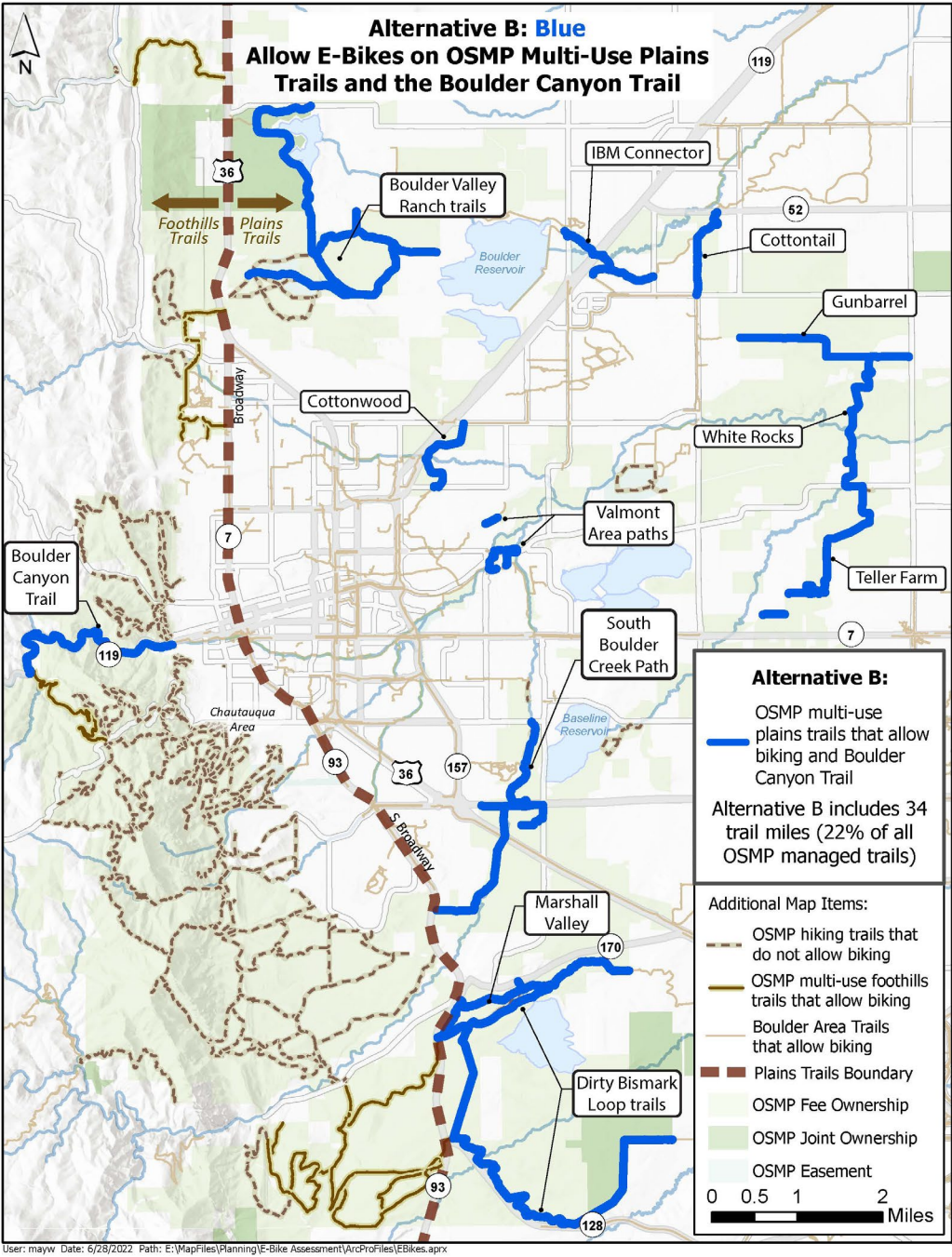

IMPLEMENTATION  
Designate & Manage Trails  
Process (How):  
1. City Manager Rule

# City Manager Rule

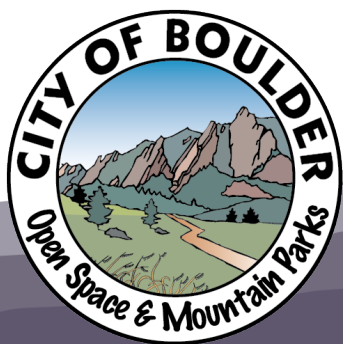
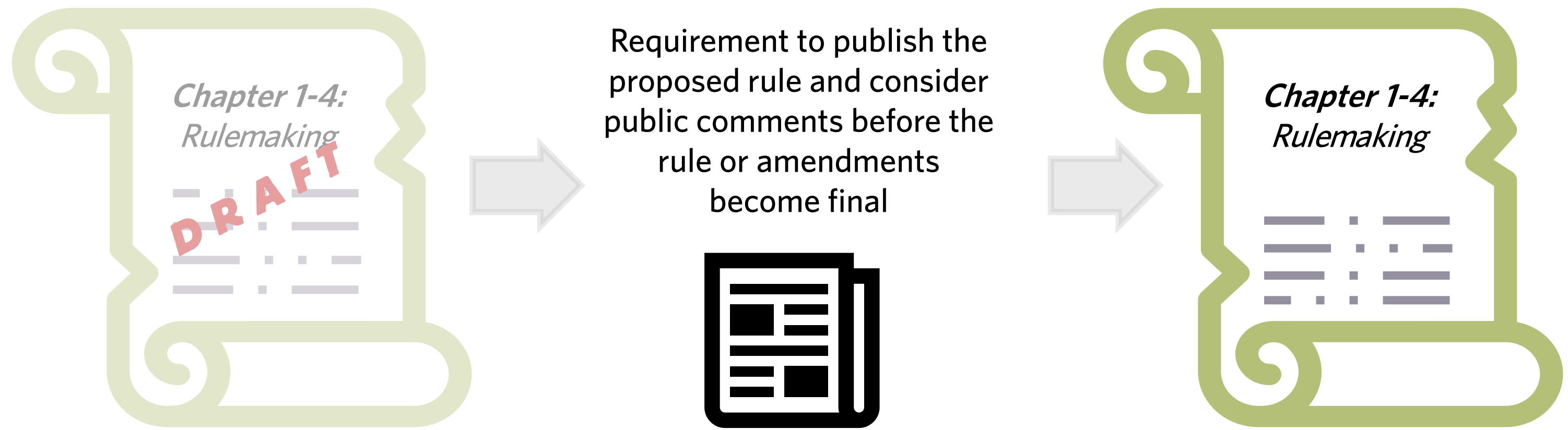

IMPLEMENTATION

Designate & Manage Trails

Process (How):

1. City Manager Rule

# Alternative to City Manager Rule

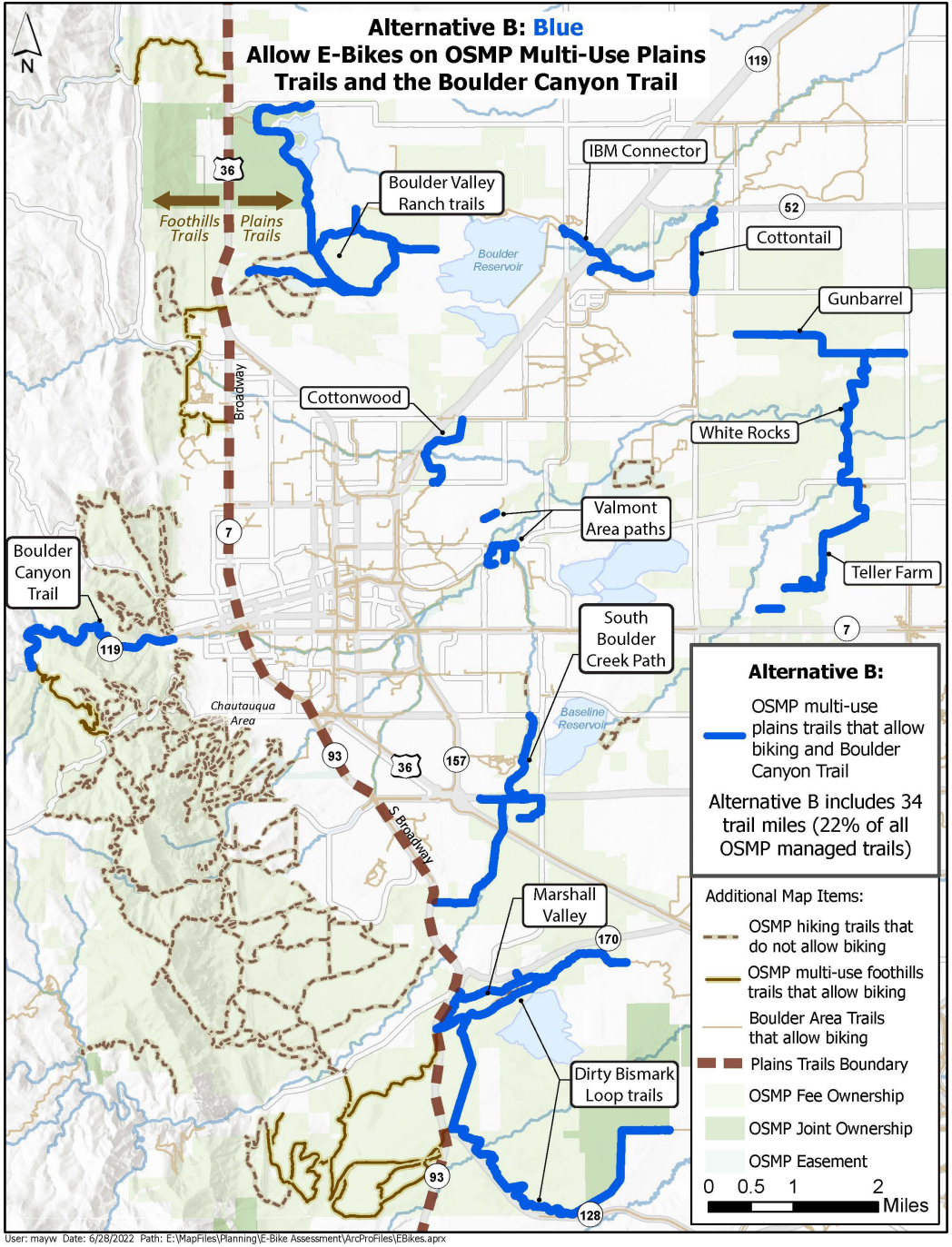
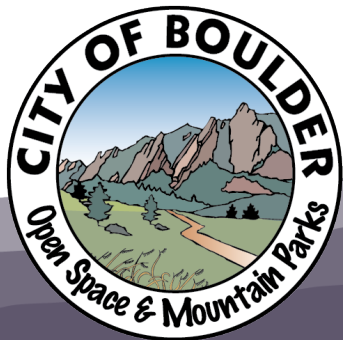
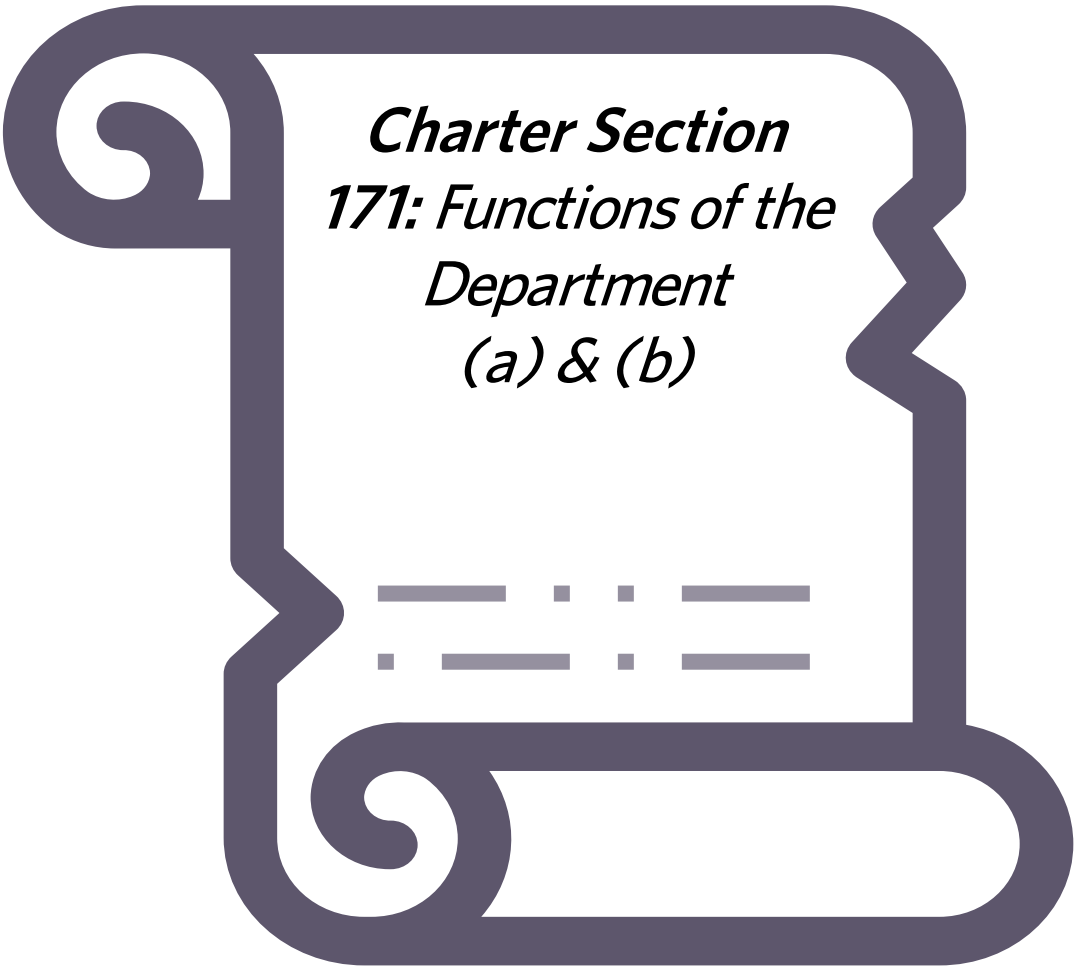



# Staff Recommendation

**Staff requests the Open Space Board of Trustees make a motion to:**

**1**

## **POLICY:**

Recommend the Boulder City Council allow class 1 and class 2 e-biking as a passive recreational activity permissible on open space on trails where designated by the City Manager,

**and**

**2**

## **IMPLEMENTATION:**

Recommend the OSMP Department proceed with the staff preferred alternative to implement this policy by designating and managing the trails in Alternative B - Plains trails located east of Broadway that allow biking, and the Boulder Canyon Trail for e-biking.

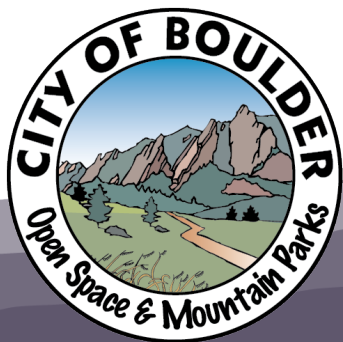

# Next Steps

## Spring 2022 Alternatives Evaluation

- Develop criteria
- Evaluate alternatives
- Identify preliminary proposal

## Summer 2022 Community Engagement

- Online questionnaire
- Onsite survey
- Office hours

## Fall 2022 Additional Analysis

- **Nov. 9:** Results and Preliminary staff recommendation
- Board request for additional information

## Winter 2023 Board Consideration

- **Dec. 14:** Public Hearing & Final Staff Recommendation
- **Feb. 8:** Board recommendation to City Council

## Spring 2023 Council Consideration

We are  
Here

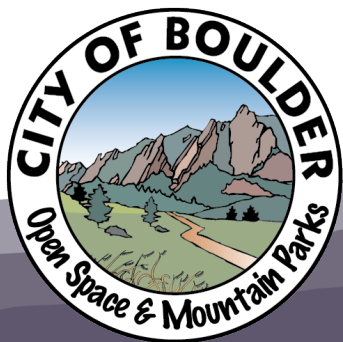

**Thank You!**



**Questions?**

