

NOTES:

1. REFER TO CITY OF BOULDER'S APPROVED TREE LIST FOR ACCEPTABLE SPECIES FOR PLANTING WITHIN PUBLIC R.O.W. CONIFEROUS TREES SHALL NOT BE PLANTED IN THE PUBLIC R.O.W.
2. TREE SPECIES SHALL BE SELECTED TO ENSURE MINIMUM VERTICAL CLEAR SPACE OF 8' CAN BE MAINTAINED WITHIN SIDEWALKS. IN CONSTRAINED URBAN SETTINGS, SPECIES SHALL BE SELECTED TO ENSURE ADEQUATE PEDESTRIAN SPACE.
3. SEE DETAIL XX.X FOR TREE PLACEMENT AT INTERSECTIONS AND TYPICAL TREE SPACING

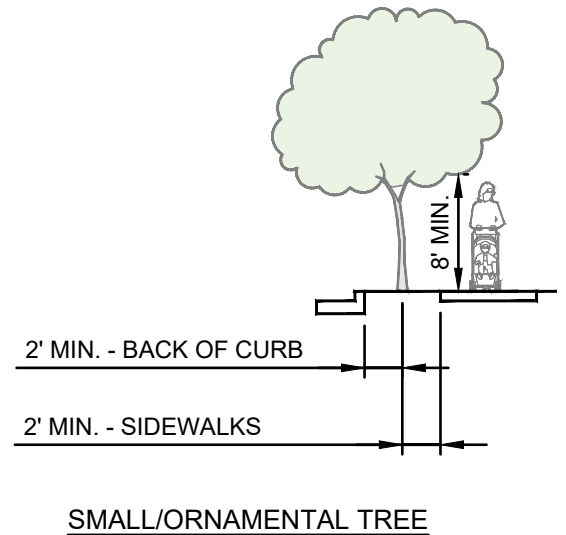
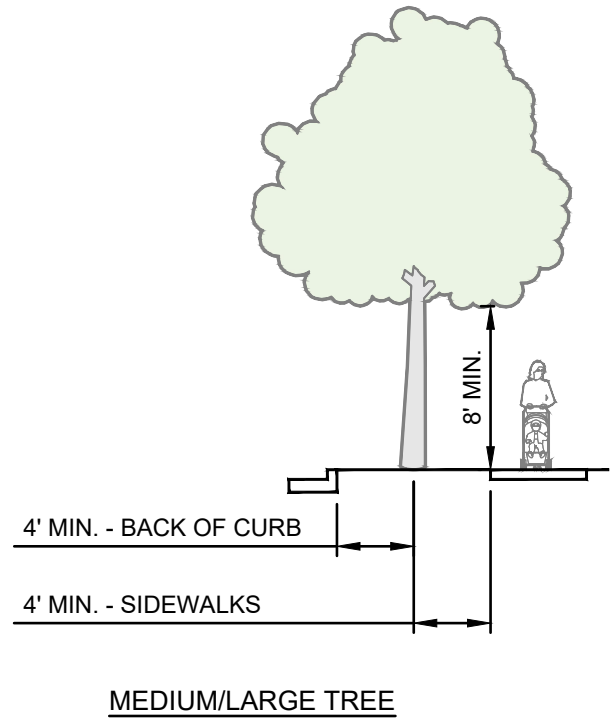
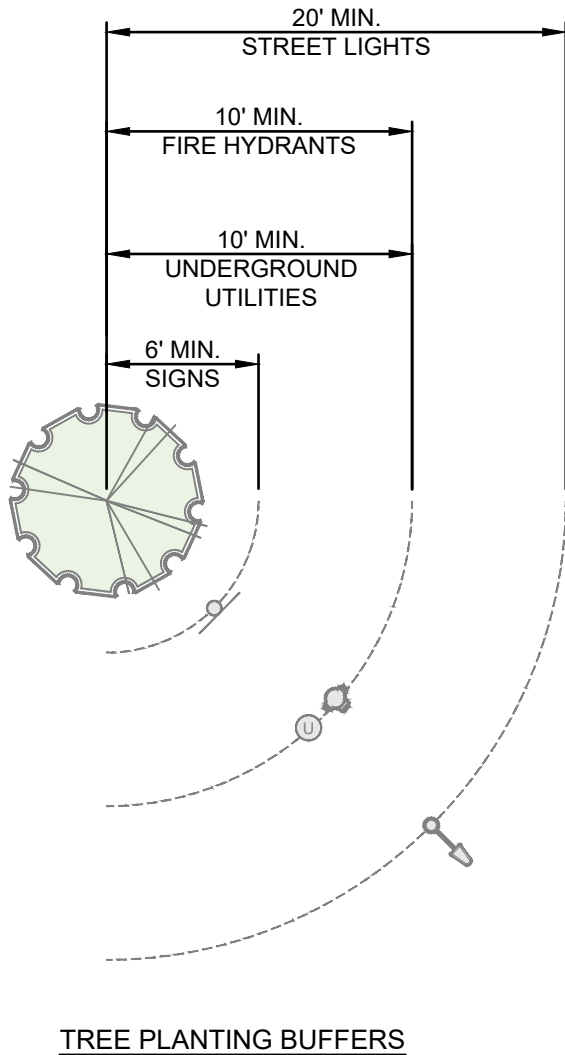

DRAWN BY: KW
 CHECKED BY: JC
 APPROVED BY:
 DIRECTOR OF PUBLIC WORKS

CITY OF BOULDER, COLORADO
 STREETSCAPE
 TREE SPACING AND
 LOCATION

ISSUED: JAN 02, 2023
 REVISED: JAN 02, 2023

DRAWING NO.
 3.01b