

TYPICAL VALLEY GUTTER WITH
RADII AND STEEL PATTERN SHOWN

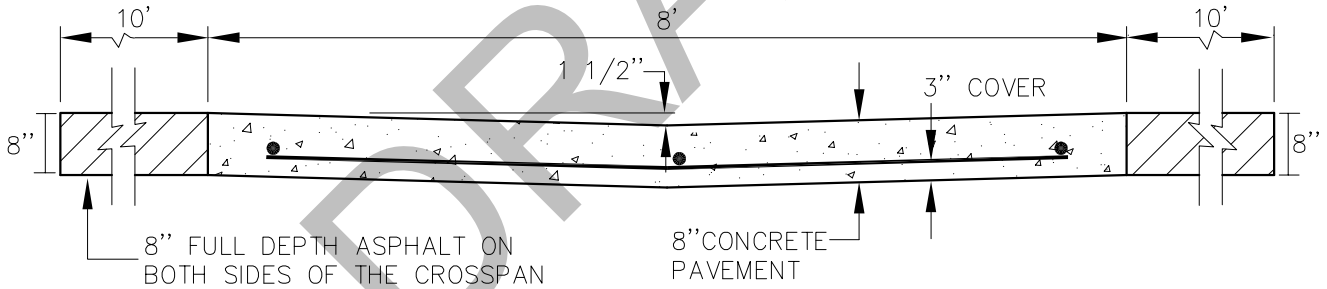

SECTION "A-A" OF PAN

NOTES:

1. THE LONGITUDINAL GRADE ALONG THE FLOWLINE OF THE CURB RETURN SHALL BE 0.50% MINIMUM.
2. WHEN CONSTRUCTING DIFFERENT WIDTH STREETS, REINFORCING STEEL LENGTHS WILL CHANGE ACCORDINGLY BUT THE PATTERN WILL REMAIN THE SAME.

DRAWN BY: JSH
CHECKED BY: RJH

APPROVED BY:
DIRECTOR OF PUBLIC WORKS

CITY OF BOULDER, COLORADO
CROSSPAN AND RADII
CURB RETURN ACCESSES

ISSUED: JULY 2, 1998
REVISED: MAR. 16, 2022

DRAWING NO.

2.03